



perma STAR VARIO

安裝手冊

解決潤滑問題的專家

perma

標準安裝作業程序 (SOP)

請跟隨步驟流程操作

- 1 組裝所有零組部件 (主機, 電池組, 油罐)
- 2 轉動螺紋環與油罐緊密接合, 直到白色的倒三角型箭頭標誌完全可被看見
- 3 紀錄反應啟始日在油罐標籤上
- 4 長按SET鍵十秒, 依閃爍燈號選擇油罐尺寸(S60, M120, L250)
- 5 依閃爍燈號選擇反應週期(可依需求調整1 到 12 個月)
- 6 移除油罐栓塞
- 7 安裝STAR VARIO在黃油嘴上

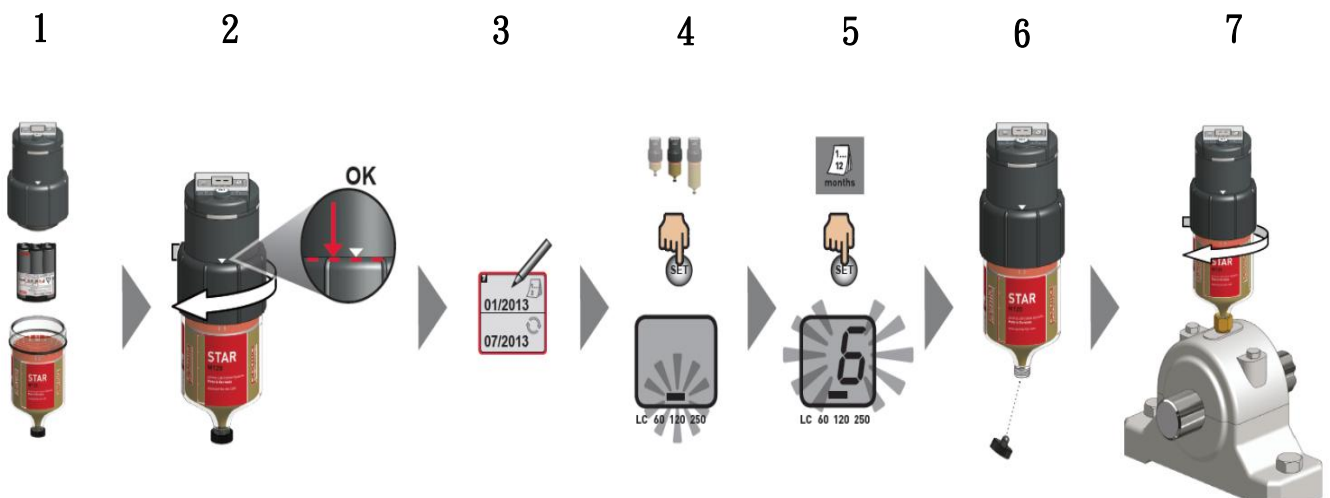

燈號顯示說明





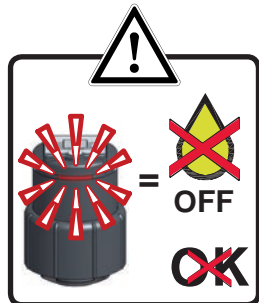





綠色燈號正常運作





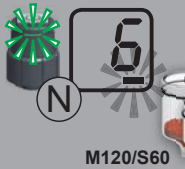

紅色燈號異常發生

SET				OK	OK
OFF ► ON	當停機時按壓SET鍵一秒 主機回復正常運作	OFF			 ON
ON ► OFF	當主機如需暫時停機 按壓SET鍵一秒			OFF	 OFF
	當油罐內油已用完紅燈警示	LL			 ON
RUN	主機正常運作	RU			 ON
	長按SET鍵十秒 強制注油模式				

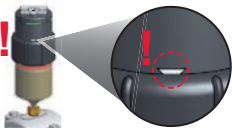
燈號顯示圖解說明

1	2	3
 <p>視窗無顯示任何訊號 表示電力狀況異常</p>		
 <p>電池低電量</p>		
 <p>注意油罐容量</p>	 <p>= S60 = M120</p>	 <p>= L250</p>
 <p>M120/S60</p>	 <p>= L250</p>	 <p>= S60 = M120</p>

1	2	3
 <p>螺紋環未轉緊</p>		 <p>OK</p>
 <p>錯誤</p>		
 <p>油道壓力大於6bar</p>		 <p>OK</p>
 <p>工作溫度小於-10度</p>		 <p>OK</p>

組裝 部件



1



2



3

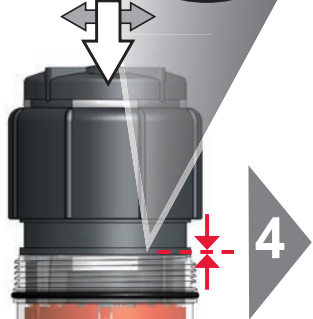
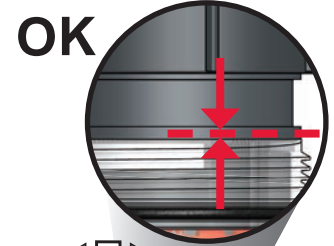
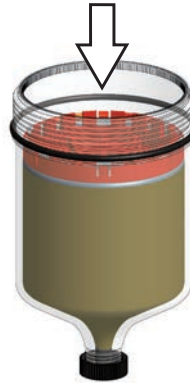

4

初次設定

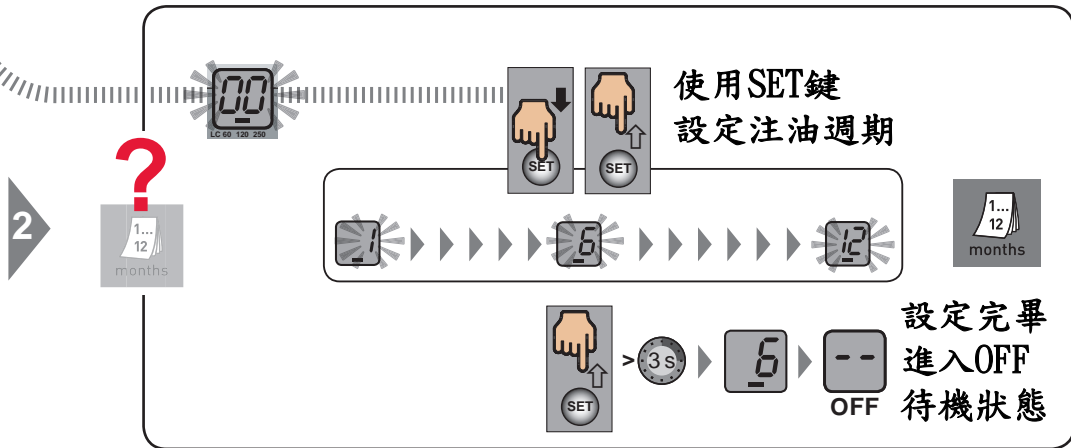
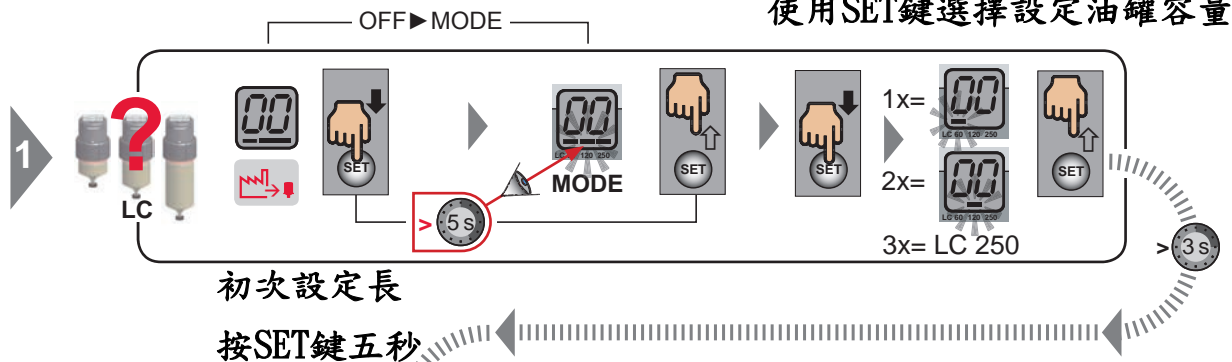

蓋上防塵蓋

油罐更換

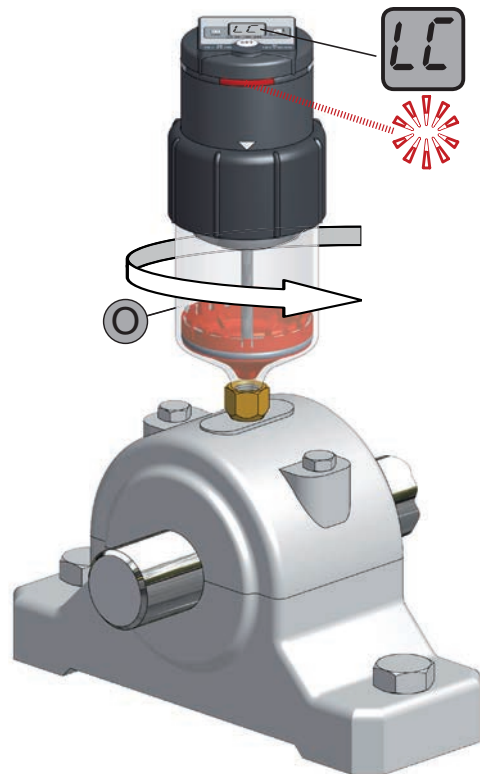
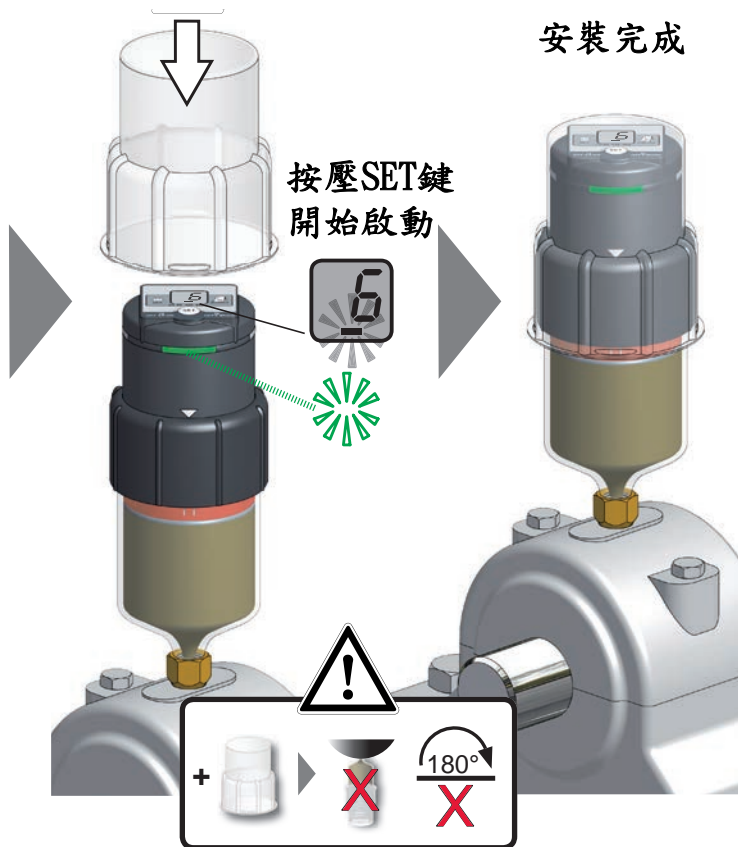

從油孔
上取下
STAR
VARIO

轉動螺紋環取下空油罐

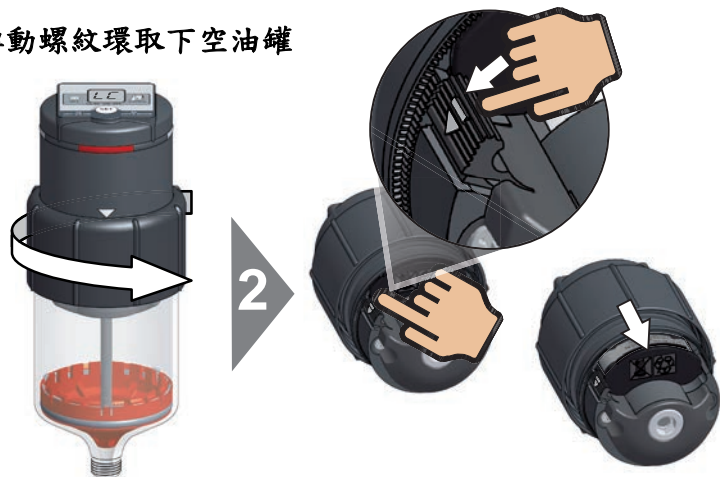
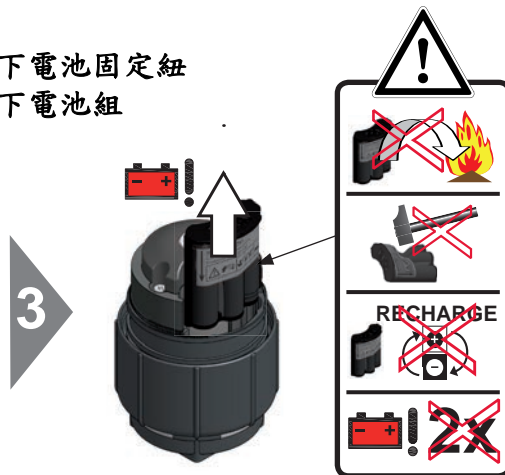
按下電池固定鈕
卸下電池組

安裝電池組

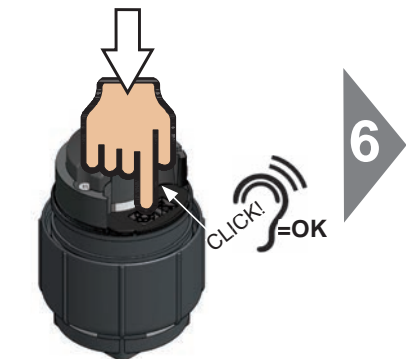

確認電池組是否安裝正確



主機閃爍綠燈

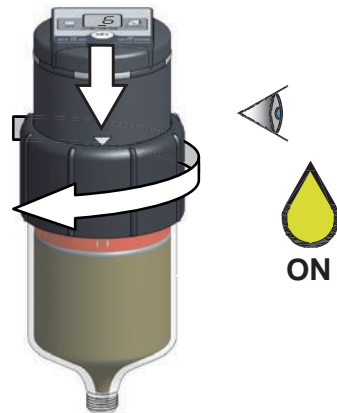

裝上油罐